

FOR SALE OR LEASE

Manchester, Connecticut

117 BUCKLAND STREET



0.41 ACRE PARCEL WITH TWO LEVEL BUILDING

117 Buckland Street is located directly at the entrance onto Interstate 84. The building is two levels with 2154 sf on main level and 998 sf in basement. There is pylon directly on Buckland Street with ample parking in the back. The site has great access and excellent visibility to Route 84.

Great opportunity to own or lease in the heart of Manchester's critical retail corridor.

Powers &
Company

Representing Retail Landlords Throughout New England

Manchester, Connecticut

117 BUCKLAND STREET

Specifications

Location	117 Buckland Street Manchester, CT
Available Space	2,154 SF First Floor 998 SF Basement Former Squire Tux and Liberty Travel
Acres	0.41
Dimensions	First Floor – 73' 10" x 28' 10" Basement – 34' 7" x 28' 10"
Zoning	GB
Year Build	1954
Special Features	Brick Fireplace

Demographics	5 Miles	10 Miles	15 Miles
Median House Hold Income	\$65,400	\$54,809	\$61,549

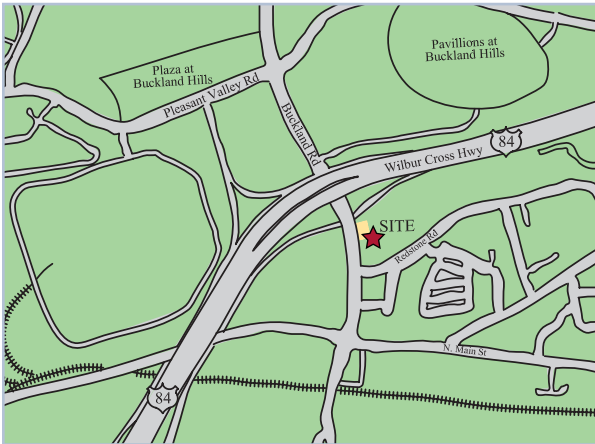
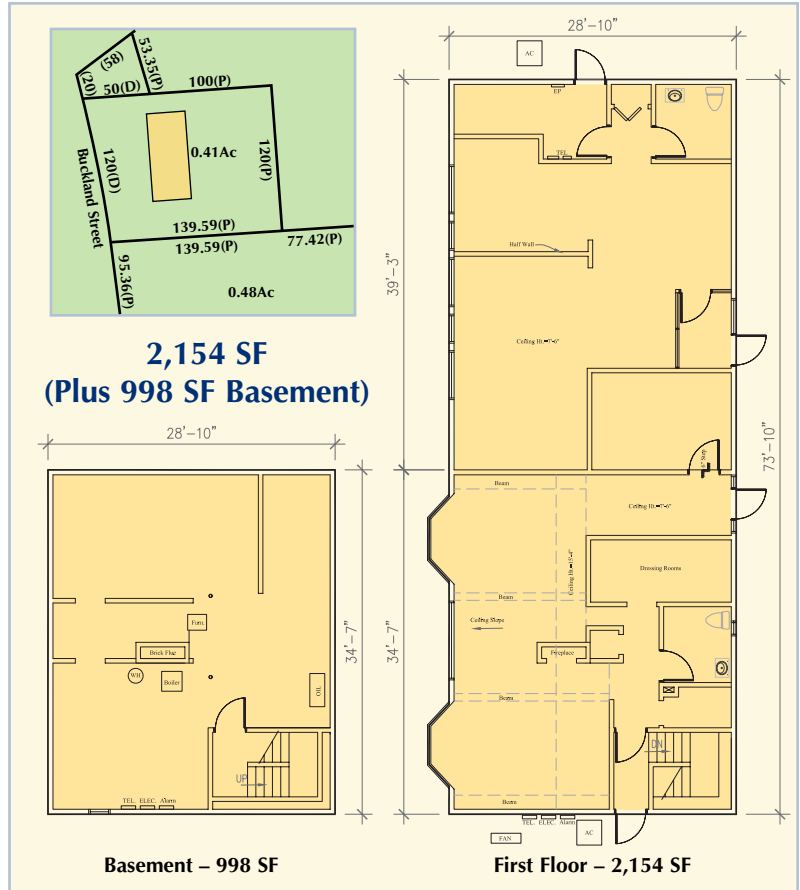

For more information or to schedule a tour,
please call or e-mail Mary Powers at 781-334-4661,
powers.co@verizon.net

Powers & Company

Representing Retail Landlords Throughout New England

P.O. Box 435 • Lynnfield, MA 01940 • (781) 334-4661
E-mail: powers.co@verizon.net • www.powersandco.com